

NAMOND ETAL
25.582 AC
127/946

250/335

J. KARNER
3.06 AC
074/772

1 ONG
1 AC

D. HUGHES
1.37 AC

R. ELLISON
1.94 AC

R. ELLISON
1.77 AC

D. PROFFER
4.538 AC

JR. OMENS
10 AC

E. BEVING
10 AC

C. SPARKS
10.394 AC

1179/478

074/1146

R. SPENCE OIL CO
6.6 AC
1067/099

K. WHITE
5 AC

A. NEBB
2 AC

J. DIAMOND
2.5 AC
1314/261

D. MOLLAN
10 AC

L. MEDINA ET AL
10 AC

R. REED
10.7 AC
302/564

T. QUACA
2.51 AC

M. BEEVERS
16 AC

D. LEWIS
16 AC

K. AD.
25
1180

J. HALFORD
5 AC
1195

K. WINTER
3.7 AC
1291

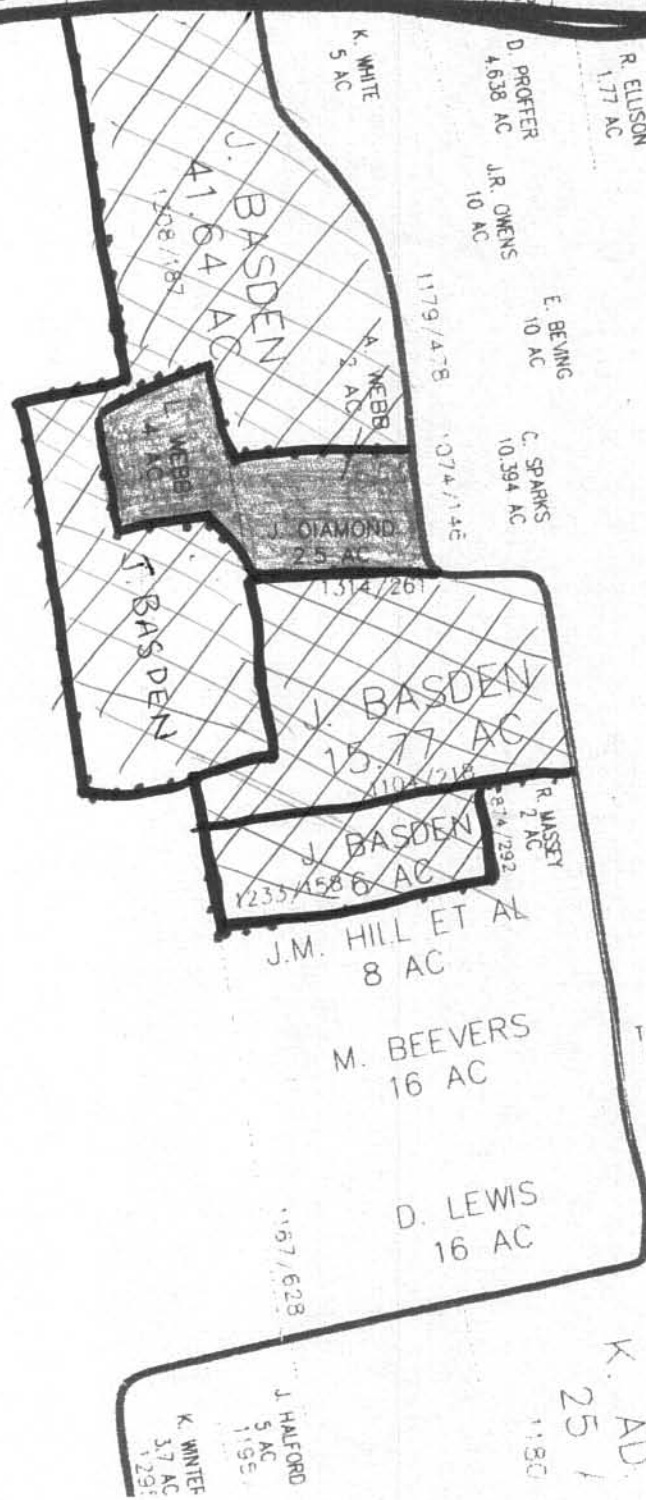

R. LITTLEJOHN
16.98 AC
227/387

J.B. HILL
15 AC
270/819

C. LEWIS
10.729 AC
139/141

C. LEWIS
15.1 AC
1321/320

J. BASDEN
44.49 AC
945/777

C. WHEELER
80 AC
833/439

E. ST
01

60.71 Acres
41.64 OR 21.77 sold separately